

*** 3941 H Series ***

Material :

* Insulator :Nylon 6/6

* Contact : Brass

3941P ** H ** *0
 $\frac{1}{1} \frac{2}{2} \frac{3}{3}$

1. No. of circuits

2. Plating:

0= Tin plated 120u"min. over 30u" min.nickel overall

U=Gold flash over 30u" min. nickel overall

3.00=Material Nylon66 UL94-0

E0=Material Nylon66 UL94-2

RoHS COMPLIANT

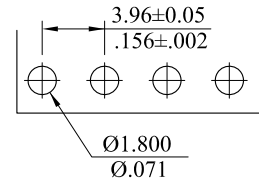
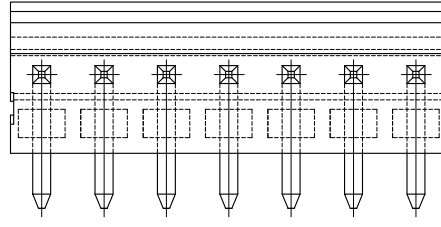
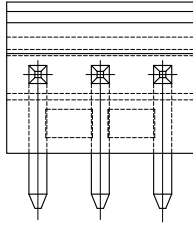

Recommended Hole Pattern

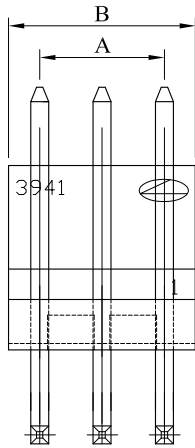

2 through 3 circuits

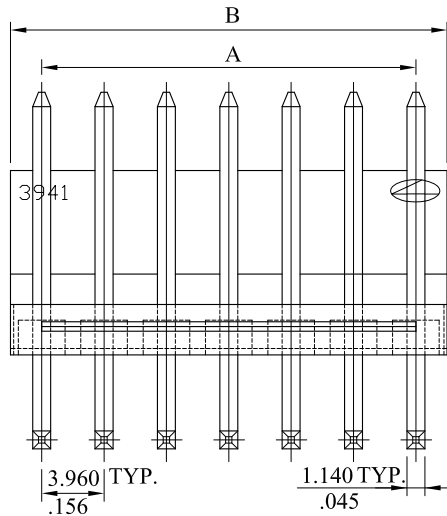

4 through 20 circuits

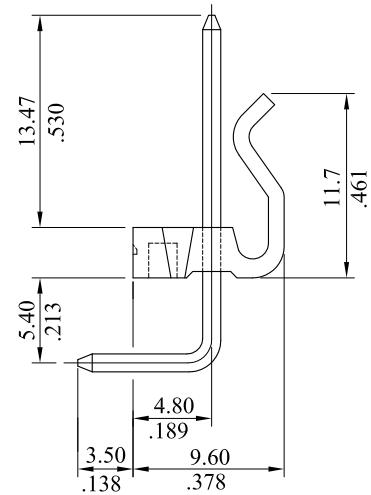

Circuits	Part No.	Dimension	
		A	B
2	3941P02H*00	3.96±0.15(.156±.006)	7.9±0.30(.311±.012)
3	3941P03H*00	7.920±0.15(.312±.006)	11.9±0.30(.469±0.12)
4	3941P04H*00	11.88±0.20(.468±.008)	15.8±0.30(.622±.012)
5	3941P05H*00	15.84±0.20(.624±.008)	19.8±0.30(.780±.012)
6	3941P06H*00	19.80±0.20(.780±.008)	23.8±0.30(.937±.012)
7	3941P07H*00	23.76±0.20(.936±.008)	27.7±0.30(1.091±.012)
8	3941P08H*00	27.72±0.20(1.092±.008)	31.7±0.30(1.248±.012)
9	3941P09H*00	31.68±0.20(1.248±.008)	35.6±0.30(1.402±.012)
10	3941P10H*00	35.64±0.30(1.403±.012)	39.6±0.40(1.559±.016)
11	3941P11H*00	39.60±0.30(1.560±.012)	43.6±0.40(1.717±.016)
12	3941P12H*00	43.56±0.30(1.716±.012)	47.5±0.40(1.870±.016)
13	3941P13H*00	47.52±0.30(1.871±.012)	51.5±0.40(2.028±.016)
14	3941P14H*00	51.48±0.30(2.027±.012)	55.4±0.40(2.181±.016)
15	3941P15H*00	55.44±0.30(2.183±.012)	59.4±0.40(2.339±.016)
16	3941P16H*00	59.40±0.30(2.339±.012)	63.4±0.40(2.496±.016)
17	3941P17H*00	63.36±0.30(2.494±.012)	67.3±0.40(2.650±.016)
18	3941P18H*00	67.32±0.30(2.650±.012)	71.3±0.40(2.807±.016)
19	3941P19H*00	71.28±0.30(2.806±.012)	75.2±0.40(2.961±.016)
20	3941P20H*00	75.24±0.30(2.962±.012)	79.2±0.40(3.118±.016)

REV.	G	ES110536	LEOCO CORPORATION GENERAL TOLERANCES: (UNLESS SPECIFIED) <table border="1"> <thead> <tr> <th></th> <th>mm</th> <th>inch</th> </tr> </thead> <tbody> <tr> <td>1 PLACE</td> <td>± 0.30</td> <td>± --</td> </tr> <tr> <td>2 PLACES</td> <td>± 0.20</td> <td>± .012</td> </tr> <tr> <td>3 PLACES</td> <td>± 0.10</td> <td>± .008</td> </tr> <tr> <td>4 PLACES</td> <td>± --</td> <td>± .004</td> </tr> </tbody> </table> ANGULAR ± (1°)		mm	inch	1 PLACE	± 0.30	± --	2 PLACES	± 0.20	± .012	3 PLACES	± 0.10	± .008	4 PLACES	± --	± .004	APPROVED: Chard	PART NO.: 3941P**H**0			
		mm		inch																			
	1 PLACE	± 0.30		± --																			
	2 PLACES	± 0.20		± .012																			
	3 PLACES	± 0.10		± .008																			
	4 PLACES	± --		± .004																			
F	ES110510	DATE:	CHECKED: Angel	TITLE: HEADER																			
E	ES101227		DATE:	DRAWN: smile	DRAWING NO.: 394106S																		
D	ES091235	DATE:	UNITS <table border="1"> <thead> <tr> <th>SCALE</th> <th>SIZE</th> <th>SHEET</th> <th>REV.</th> </tr> </thead> <tbody> <tr> <td>2:1</td> <td>A4</td> <td>1/1</td> <td>G</td> </tr> </tbody> </table>	SCALE	SIZE	SHEET	REV.	2:1	A4	1/1	G												
SCALE	SIZE			SHEET	REV.																		
2:1	A4	1/1	G																				
A	DWG REL																						
ECO. NO.	CHG.	APP.																					