

RoHS COMPLIANT

CUSTOMER DRAWING

| REV. | ECO. NO. | DESCRIPTION | DATE |
|------|-----------|-------------|------------|
| A | DWG. REL. | APPROVED | 2017.07.31 |

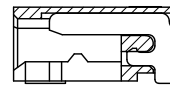
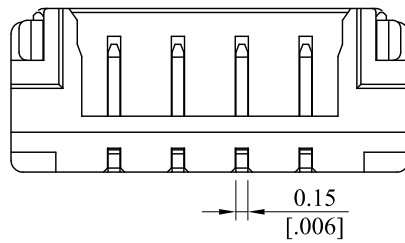
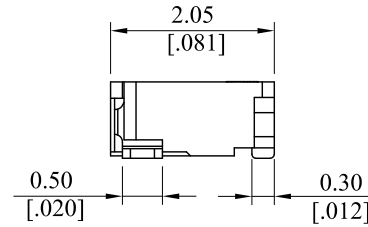
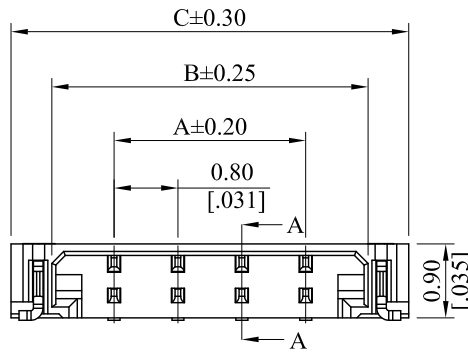

Section A-A

Note:

Material:

- Housing: High Temperature Thermoplastic, UL94 V - 0, Black
- Contact: Copper alloy, $t=0.15\text{mm}$
- Solder tab: Copper alloy, $t=0.12\text{mm}$, Matte Tin plated over Nickel

General Part Number:

0810P**MHU0

1 2

1.No. of circuits (2,4)

2.Plating

U = Gold flash over $30\mu\text{m}$ min. Nickel underplating overall

A = 0.80mm (.031") * No. of spaces

B = $A + 1.45\text{mm}$ (.057")

C = $A + 2.60\text{mm}$ (.102")

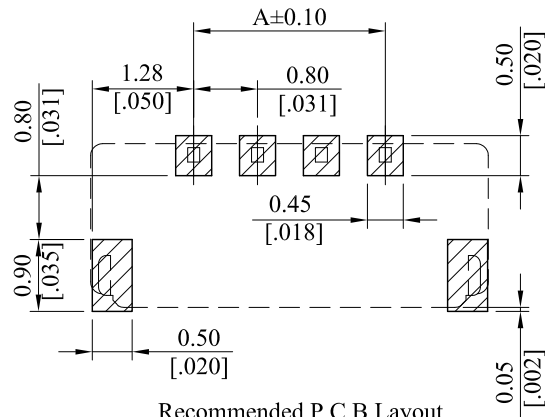

Recommended P.C.B Layout

General Tolerance: ± 0.05

| TOLERANCE UNLESS OTHERWISE SPECIFIED | | | LEOCO CORPORATION http://www.leoco.com.tw | | |
|--------------------------------------|------------------|------------------|--|------------|--------------------------|
| mm | mm | inch | APPROVED BY: | DATE: | TITLE: |
| [inch] | | | Chard | 2017.09.11 | 0.80mm Pitch wafer |
| | | | Checked BY: | DATE: | |
| 1 PLACE | ± 0.30 | $\pm \text{---}$ | Angel | 2017.09.11 | PART NO.: 0810P**MHU0 |
| 2 PLACES | ± 0.20 | $\pm .012$ | Brian | 2017.09.11 | |
| 3 PLACES | ± 0.10 | $\pm .008$ | | | |
| 4 PLACES | $\pm \text{---}$ | $\pm .004$ | | | |
| ANGULAR $\pm 1^\circ$ | | | SIZE: A3 | SCALE: 1:1 | DRAWING NO.: 081001S |
| | | | | | REV.: A |
| | | | | | SHEET: 1 OF 1 |