

RoHS COMPLIANT

- \* Housing: Nylon 6T, UL94V-0
- \* Cap: Nylon 6T, UL94V-0
- \* Contact: Copper alloy
- \* Tab: Copper alloy

Ordering Information:  
 1262 P \*\* 0 \* \* B  
 1 2 3 4 5

1. No. of Contacts: (10, 20, 30 & 40 Contacts)
2. 0=Dual Row SMT type
3. Plating:
  - 0= Tin plated
  - F= Selective gold flash
  - U= Gold flash
4. Packaging:
  - 0= With Tube
  - 1= With Tape & Reel
5. No. Symbol:
  - B= With Guide Post

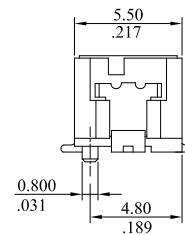
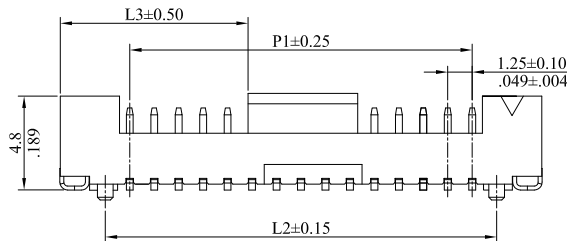
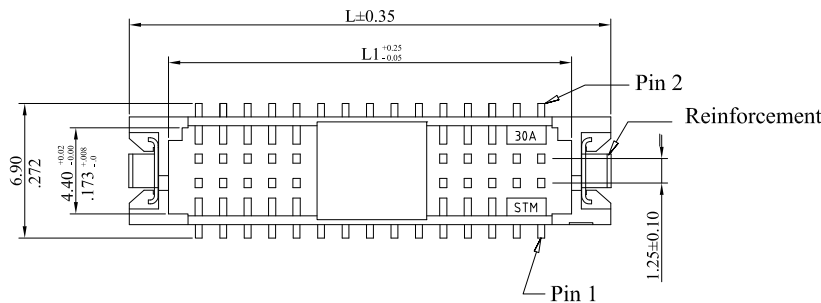
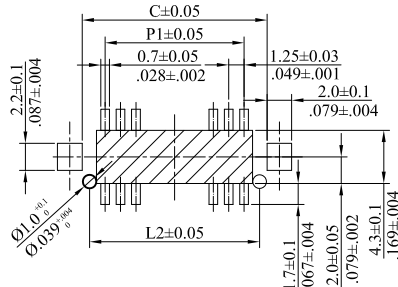

Contact	L	L1	L2	L3	P1	C
10	12.10(.476)	8.10(.319)	7.50(.295)	3.30(.130)	5.00(.197)	8.70(.343)
20	18.35(.722)	14.35(.565)	13.75(.541)	7.40(.291)	11.25(.443)	14.95(.559)
30	24.60(.969)	20.60(.811)	20.00(.787)	9.35(.3368)	17.50(.689)	21.20(.835)
40	30.85(1.215)	26.85(1.057)	26.25(1.033)	12.45(.490)	23.75(.935)	27.45(1.081)

G	ES140115	UPDATE DRAWING	LEOCO CORPORATION	APPROVED:	PART NO.:
F	ES101214			DATE:	1262P**0**B
E	ES080939		GENERAL TOLERANCES: (UNLESS SPECIFIED)	CHECKED:	TITLE:
D	ES051133			DATE:	Male Header SMT Type
C	ES050841		1 PLACE ± 0.30 ± --	DRAWN:	DRAWING NO.:
REV.	ECO. NO.	DISCRIPTION	2 PLACES ± 0.20 ± .012	SMILE	126201S
			3 PLACES ± 0.10 ± .008	DATE:2014.01.09	
			4 PLACES ± -- ± .004		UNITS
			ANGULAR ± ( 1° )		SCALE
					SIZE
					SHEET
					REV.