

Material :

* Insulator : UL 94V-0, PA6T

* Contact : Brass

* Plating :

T = Tin plated 120u"min. over 30u"min.nickel overall

U = Gold flash over 30u"min. nickel overall

F = Selective gold flash over 30u"min. nickel overall

J = 15u"min. gold plated selective over 30u"min. nickel overall

K = 30u"min. gold plated selective over 30u"min. nickel overall

RoHS COMPLIANT

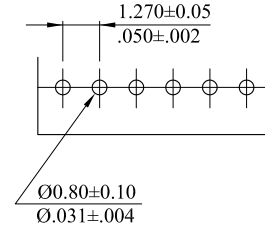
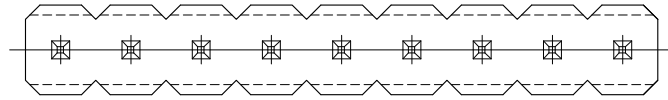

Recommended Hole Pattern

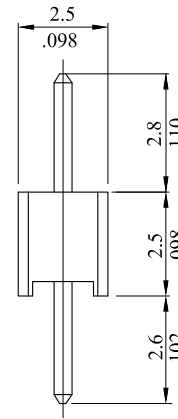
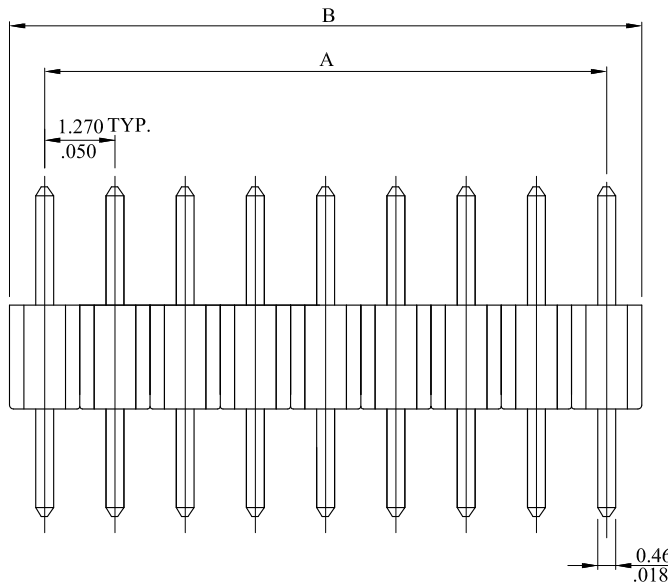

Circuits	DimA	Dim.B	Circuits	DimA	Dim.B	Circuits	DimA	Dim.B
2	1.270(.050)	2.54(.100)	15	17.780(.700)	19.05(.750)	28	34.290(1.350)	35.56(1.400)
3	2.540(.100)	3.81(.015)	16	19.050(.750)	20.32(.800)	29	35.560(1.400)	36.83(1.450)
4	3.810(.015)	5.08(.200)	17	20.320(.800)	21.59(.850)	30	36.830(1.450)	38.10(1.500)
5	5.080(.200)	6.35(.250)	18	21.590(.850)	22.86(.900)	31	38.100(1.500)	39.97(1.574)
6	6.350(.250)	7.62(.300)	19	22.860(.900)	24.13(.950)	32	39.970(1.574)	40.46(1.593)
7	7.620(.300)	8.89(.350)	20	24.130(.950)	25.40(1.000)	33	40.460(1.593)	41.91(1.650)
8	8.890(.350)	10.16(.400)	21	25.400(1.000)	26.67(1.050)	34	41.910(1.650)	43.18(1.700)
9	10.160(.400)	11.43(.450)	22	26.670(1.050)	27.94(1.100)	35	43.180(1.700)	44.45(1.750)
10	11.430(.450)	12.70(.500)	23	27.940(1.100)	29.21(1.150)	36	44.450(1.750)	45.72(1.800)
11	12.700(.500)	13.97(.550)	24	29.210(1.150)	30.48(1.200)	37	45.720(1.800)	46.99(1.850)
12	13.970(.550)	15.24(.600)	25	30.480(1.200)	31.75(1.250)	38	46.990(1.850)	48.26(1.900)
13	15.240(.600)	16.51(.650)	26	31.750(1.250)	33.02(1.300)	39	48.260(1.900)	49.53(1.950)
14	16.510(.650)	17.78(.700)	27	33.020(1.300)	34.29(1.350)	40	49.530(1.950)	50.80(2.000)

				LEOCO CORPORATION		APPROVED:		PART NO.: 1271P***000			
				GENERAL TOLERANCES: (UNLESS SPECIFIED)		DATE:		TITLE: 1.270mm(.050") Single Row Breakaway Header			
C	ES101214				mm	inch	CHECKED:		DRAWING NO.: 127101S		
B	ES060304			1 PLACE	± 0.30	± ---	DATE:				
A	DWG REL			2 PLACES	± 0.20	± .012	DRAWN:		SCALE SIZE SHEET REV. 4:1 A4 1/1 C		
REV.	ECO. NO.	CHG.	APP.	3 PLACES	± 0.10	± .008	DATE:				
				4 PLACES	± ---	± .004	ANGULAR ± (1°)				