

RoHS COMPLIANT

CUSTOMER DRAWING			
REV.	ECO. NO.	DESCRIPTION	DATE
A	DWG. REL.	APPROVED	2017.09.15
B	ES171102	C-7:02~16P→2~8P	2017.11.1
C	ES171120	Revise Layout Dimensions	2017.11.24

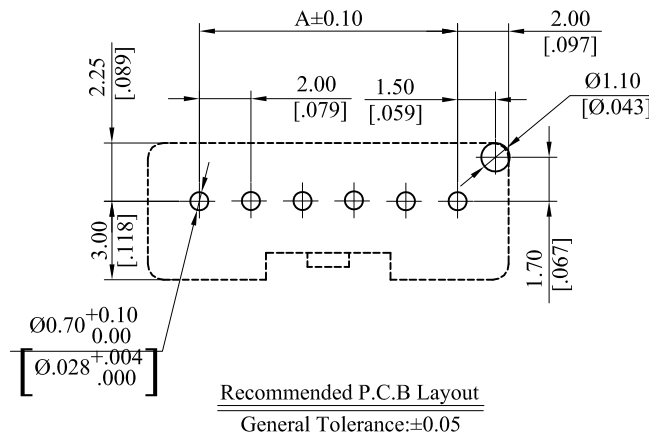
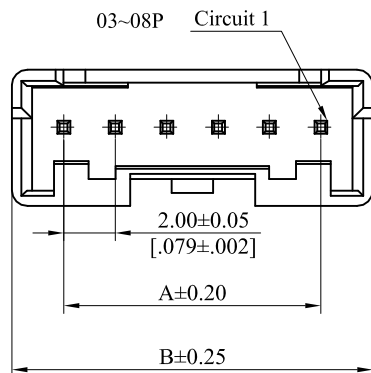
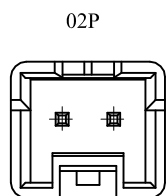

Note:
Material:
Insulator:PA66, UL94 V-0,White
Contact: Copper alloy

General Part Number:
2029P**VT01
1 2
1.No. of circuits (2~8P)
2. Plating:
T= Tin plated 80u"min.over 30u"min.Nickel
underplating overall

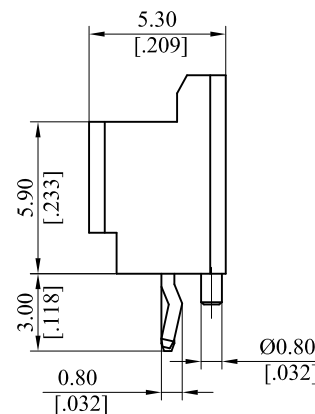
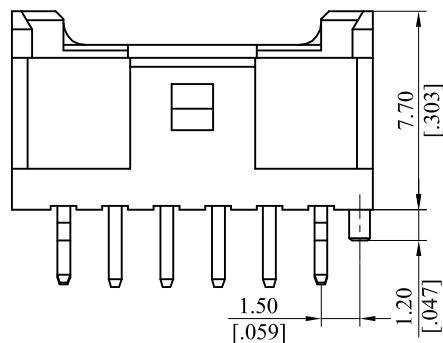
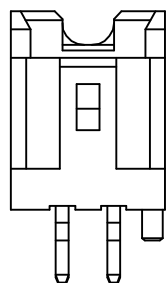

A=2.00mm*(No.of spaces)
B=A+4.00mm

TOLERANCE UNLESS OTHERWISE SPECIFIED			LEOCO CORPORATION http://www.leoco.com.tw		
mm	mm	inch	APPROVED BY:	DATE:	TITLE:
[inch]			Chard	2017.11.24	2.0mm Pitch Wafer Vertical Type
1 PLACE	± 0.30	± ---	CHECKED BY:	DATE:	
2 PLACES	± 0.20	± .012	Cedric	2017.11.24	PART NO.: 2029P**VT01
3 PLACES	± 0.10	± .008	DRAWN BY:	DATE:	
4 PLACES	± ---	± .004	Jim	2017.11.24	DRAWING NO.: 202904S
ANGULAR ±1°			SIZE:	SCALE:	
			A3	1:1	C
			SHEET:		1 OF 1