

RoHS COMPLIANT

CUSTOMER DRAWING			
REV.	ECO. NO.	DESCRIPTION	DATE
B	ES010080		
C	ES050102		
D	ES101254		
E	ES150512	Correct tolerance	2015.05.26
F	ES180115	Correct tolerance	2018.03.22

Insulator : UL 94V-0 NYLON 6/6

Contact : Brass

Ordering Information :

2502P \*\*\* 000  
1 2

1. NO. of circuits

- 0= Tin plated 120u" min. over 30u"min. nickel overall
- U= Gold flash over 30u"min. nickel overall
- Z= 30u"min. gold over 30u"min. nickel overall
- W= 15u"min. gold over 30u"min. nickel overall

CIRCUITS	PART NO.	DIMENSION	
		A	B
2	2502P020000	2.50(.098)±0.20(.008)	5.0(.197)
3	2502P030000	5.00(.197)±0.20(.008)	7.5(.295)
4	2502P040000	7.50(.295)±0.30(.012)	10.0(.394)
5	2502P050000	10.0(.394)±0.30(.012)	12.5(.492)
6	2502P060000	12.5(.492)±0.35(.014)	15.0(.591)
7	2502P070000	15.0(.591)±0.35(.014)	17.5(.689)
8	2502P080000	17.5(.689)±0.40(.016)	20.0(.787)
9	2502P090000	20.0(.787)±0.40(.016)	22.5(.886)
10	2502P100000	22.5(.886)±0.50(.020)	25.0(.984)
11	2502P110000	25.0(.984)±0.50(.020)	27.5(1.083)
12	2502P120000	27.5(1.083)±0.50(.020)	30.0(1.181)
13	2502P130000	30.0(1.181)±0.50(.020)	32.5(1.280)
14	2502P140000	32.5(1.280)±0.50(.020)	35.0(1.378)
15	2502P150000	35.0(1.378)±0.50(.020)	37.5(1.476)
16	2502P160000	37.5(1.476)±0.50(.020)	40.0(1.575)
17	2502P170000	40.0(1.575)±0.50(.020)	42.5(1.673)
18	2502P180000	42.5(1.673)±0.50(.020)	45.0(1.772)
19	2502P190000	45.0(1.772)±0.50(.020)	47.5(1.870)
20	2502P200000	47.5(1.870)±0.50(.020)	50.0(1.969)

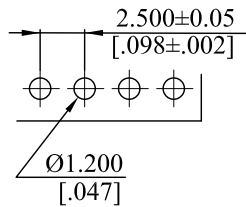
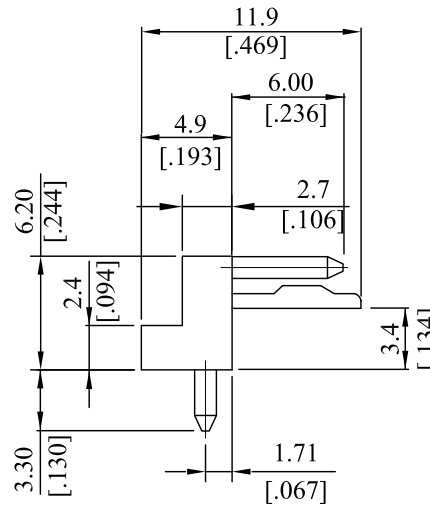
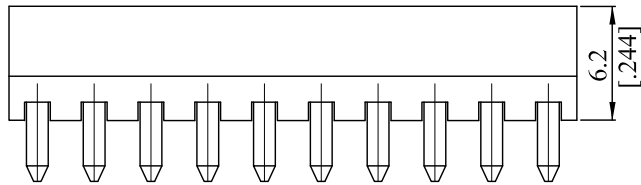
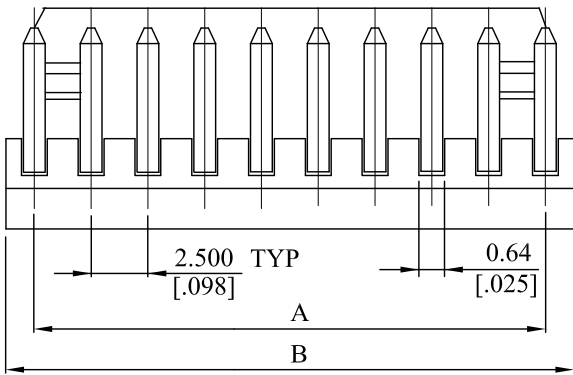

RECOMMENDED HOLE PATTERN

TOLERANCE UNLESS OTHERWISE SPECIFIED			LEOCO CORPORATION		
	mm	inch	<a href="http://www.leoco.com.tw">http://www.leoco.com.tw</a>		
1 PLACE	± 0.30	± .012	APPROVED BY:	DATE:	TITLE:
2 PLACES	± 0.20	± .008	Chard	2018.03.27	HEADER
3 PLACES	± 0.10	± .004	CHECKED BY:	DATE:	
4 PLACES	± .004		Spring	2018.03.27	
ANGULAR ±1°			DRAWN BY:	DATE:	PART NO.:
			Aimee	2018.03.22	2502P***000
			SIZE:	SCALE:	DRAWING NO.:
			A3	1:1	250203S
					REV.:
					F
					SHEET:
					1 OF 1