

RoHS COMPLIANT

CUSTOMER DRAWING

REV.	ECO. NO.	DESCRIPTION	DATE
A	DWG. REL.	APPROVED	2017.08.02
B	ES101218	Update drawing format	2010.12.16
C	ES210708	Correct tolerance: D-1:5.080±0.10→5.08±0.20	2021.07.15

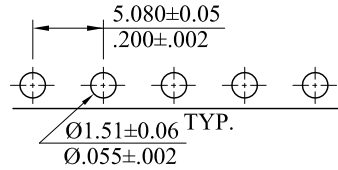
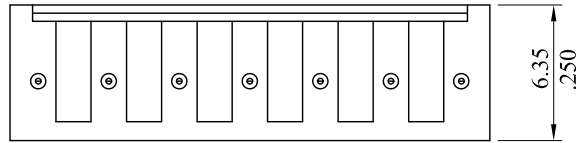

Recommended PCB Hole Dimensions

*** 5083 Series ***

Material :

* Insulstor : NYLON 6/6 UL 94V-0

* Contact : Brass

Ordering Information:

5083P ** V * 00

1 2

1. No.of circuits

2. Plating:

Y= 20µ " min.gold over 30µ " min. nickel overall

T=Tin plated 120µ " min over 30µ " min. nickel overall

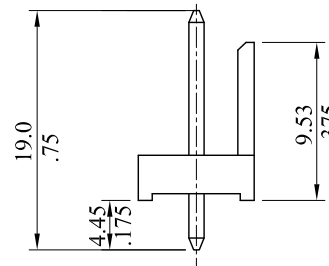
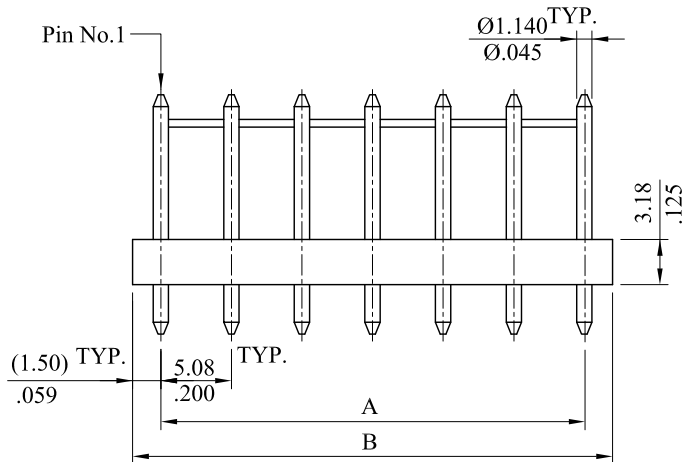

Circuits	Dimension		Circuits	Dimension	
	A	B		A	B
2	5.08(.200)	8.08(.318)	12	55.88(2.200)	58.88(2.318)
3	10.16(.400)	13.16(.518)	13	60.96(2.400)	63.96(2.518)
4	15.24(.600)	18.24(.718)	14	66.04(2.600)	69.04(2.718)
5	20.32(.800)	23.32(.918)	15	71.12(2.800)	74.12(2.918)
6	25.40(1.000)	28.40(1.118)	16	76.20(3.000)	79.20(3.118)
7	30.48(1.200)	33.48(1.318)	17	81.28(3.200)	84.28(3.318)
8	35.56(1.400)	38.56(1.518)	18	86.36(3.400)	89.36(3.518)
9	40.64(1.600)	43.64(1.718)	19	91.44(3.600)	94.44(3.718)
10	45.72(1.800)	48.72(1.918)	20	96.52(3.800)	99.52(3.918)
11	50.80(2.000)	53.80(2.118)			

TOLERANCE UNLESS OTHERWISE SPECIFIED
mm

[inch]	mm	inch
1 PLACE	± 0.30	± ---
2 PLACES	± 0.20	± .012
3 PLACES	± 0.10	± .008
4 PLACES	± ---	± .004

ANGULAR ±1°



LEOCO CORPORATION

<http://www.leoco.com.tw>

APPROVED BY: Chard
DATE: 2021.07.16

CHECKED BY: Angel
DATE: 2021.07.15

DRAWN BY: Aimee
DATE: 2021.07.15

TITLE: HEADER

PART NO.: 5083P**V*00

SIZE: A3
SCALE: 1:1

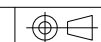

DRAWING NO.: 508301S
REV.: C
SHEET: 1 OF 1