

RoHS COMPLIANT

Specifications:

Molding Material: PA6&PA66, UL 94V-0 NO FLAME  
IEC 60335-1 rev.4

Color: Natural&White

Current Rating: 7A AC,DC

Voltage Rating: 250V AC,DC

Temperature Range: -25 °C ~+85°C

Contact Resistance: 10m Ω Max

Insulation Resistance: 1000M Ω Min

Withstanding Voltage: 1500V AC/minute

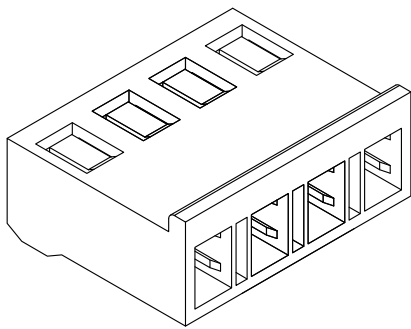
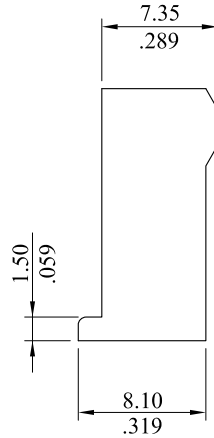
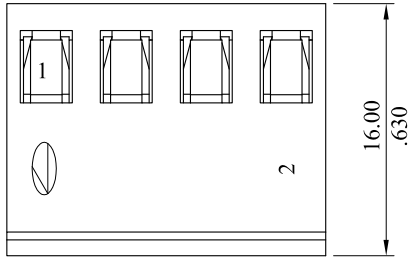
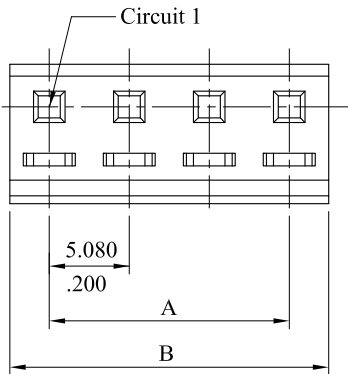

9	40.64(1.60)	45.64(1.797)
8	35.56(1.40)	40.56(1.597)
7	30.48(1.20)	35.48(1.397)
6	25.40(1.00)	30.40(1.197)
5	20.32(.800)	25.32(.997)
4	15.24(.600)	20.24(.797)
3	10.16(.400)	15.16(.597)
2	5.080(.200)	10.08(.397)
Circuits	DIM. A	DIM. B

				<b>leoco</b> LEOCO CORPORATION		APPROVED:		PART NO.:				
				GENERAL TOLERANCES: (UNLESS SPECIFIED)		DATE:		5092S**00GT				
						CHECKED:		TITLE:				
C	ES101218					DATE:		HOUSING				
						DRAWN:		DRAWING NO.:				
B	ES090824					DATE:		509201S				
						DRAWN:						
A	DWG REL					DATE:						
						DRAWN:						
REV.	ECO. NO.	CHG.	APP.			DATE:		UNITS	SCALE	SIZE	SHEET	REV.
						DATE:		$\frac{\text{mm}}{\text{inch}}$	2:1	A4	1/1	C
						DATE:						
				ANGULAR $\pm (1^\circ)$								