

\*\*\* 5714 Series \*\*\*

RoHS COMPLIANT

Material:

- \* Contact: Phosphor Bronze
- \* Plating: Tin plated 120μ " min over 30μ " min. nickel overall
- \* Wire Range: AWG 22 ~ 28

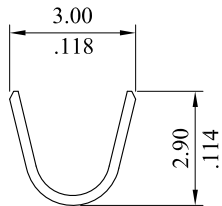
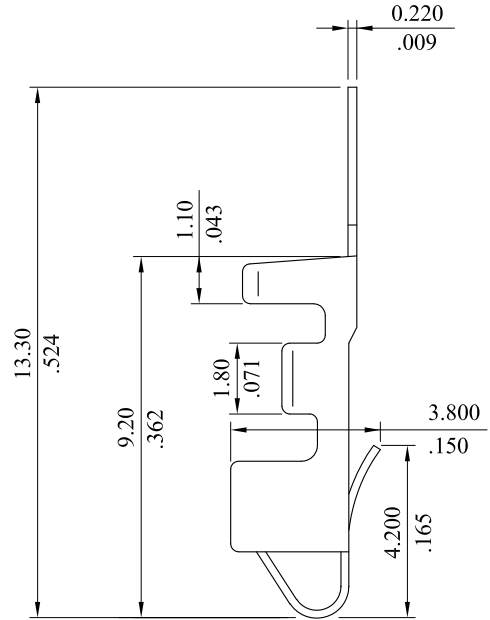
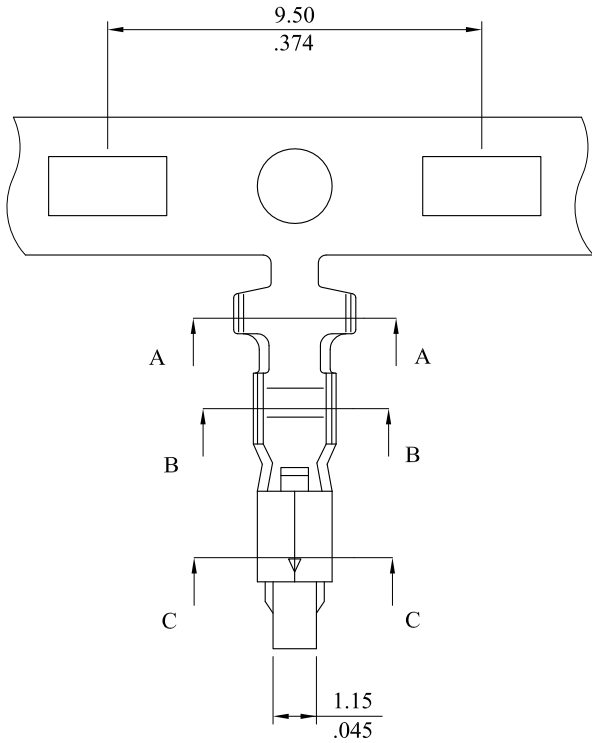

SECTION A-A

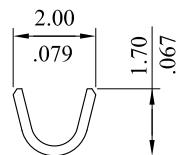

SECTION B-B

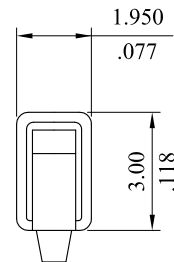

SECTION C-C

G	ES101211			<b>LEOCO CORPORATION</b>	APPROVED:	PART NO.:				
F	ES051210				GENERAL TOLERANCES: (UNLESS SPECIFIED)	DATE:	5714TPB0000			
E	E971023				CHECKED:	TITLE:				
D	E970373				DATE:	TERMINAL				
A	DWG REL				DRAWN:	DRAWING NO.:				
REV.	ECO. NO.	CHG.	APP.		DATE:	571401S				
						UNITS	SCALE	SIZE	SHEET	REV.
						mm inch	5:1	A4	1/1	G
				ANGULAR ± ( 1° )						