

RoHS COMPLIANT

Ordering Information :

7625 - 08 ** * 0
 1 2 3 4

- 1. No. of Positions:
08= 8 Positions
- 2. No. of Contacts:
02= 2 Contacts
04= 4 Contacts
06= 6 Contacts
08= 8 Contacts

Material :

- * Insulator: PBT UL94V-0
- * Contact: Phosphor Bronze

3. Plating :

- W= 15μ "min. gold over 30μ " min. nickel overall
- Z= 30μ "min. gold over 30μ " min. nickel overall
- G= 50μ "min. gold over 30μ " min. nickel overall

4. Option:

0=Black, without key, with standoff

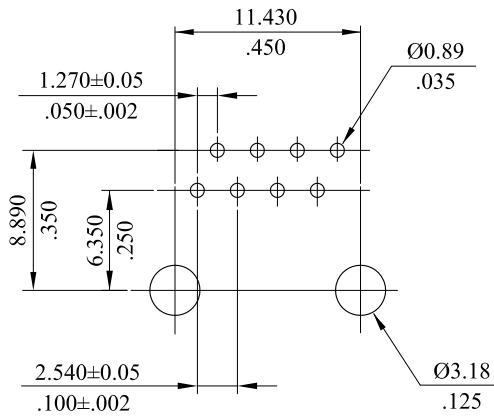
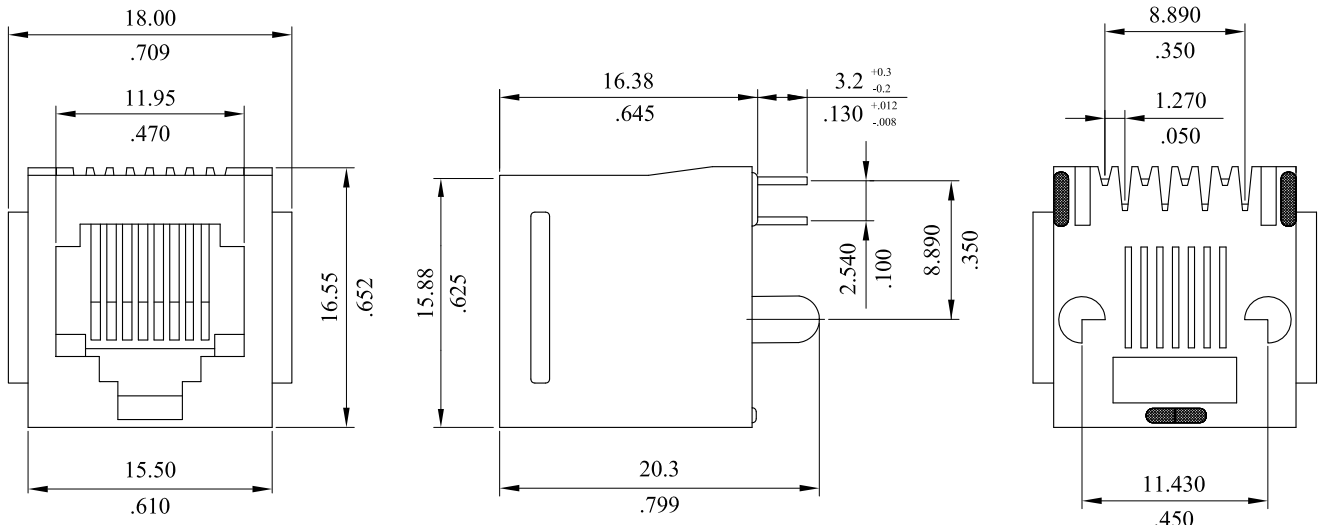

Recommended Hole Pattern

H	ES101204			LECO CORPORATION GENERAL TOLERANCES: (UNLESS SPECIFIED) <table border="1"> <thead> <tr> <th></th> <th>mm</th> <th>inch</th> </tr> </thead> <tbody> <tr> <td>1 PLACE</td> <td>± 0.30</td> <td>± --</td> </tr> <tr> <td>2 PLACES</td> <td>± 0.20</td> <td>± .012</td> </tr> <tr> <td>3 PLACES</td> <td>± 0.10</td> <td>± .008</td> </tr> <tr> <td>4 PLACES</td> <td>± --</td> <td>± .004</td> </tr> </tbody> </table>		mm	inch	1 PLACE	± 0.30	± --	2 PLACES	± 0.20	± .012	3 PLACES	± 0.10	± .008	4 PLACES	± --	± .004	APPROVED:	PART NO.:			
	mm	inch																						
1 PLACE	± 0.30	± --																						
2 PLACES	± 0.20	± .012																						
3 PLACES	± 0.10	± .008																						
4 PLACES	± --	± .004																						
G	ES071028			DATE:	7625-08***0																			
F	ES020819			CHECKED:	TITLE: PCB Mount Telephone Jack																			
E	E980281			DATE:	DRAWING NO.:																			
A	DWG REL			DRAWN:	762508S																			
REV.	ECO. NO.	CHG.	APP.	DATE:	UNITS mm / inch SCALE: 2:1 SIZE: A4 SHEET: 1/1 REV.: H																			