

RoHS COMPLIANT

CUSTOMER DRAWING			
REV.	ECO. NO.	DESCRIPTION	DATE
A	DWG. REL.	APPROVED	
B	ES161014	UPDATE	2016.10.12

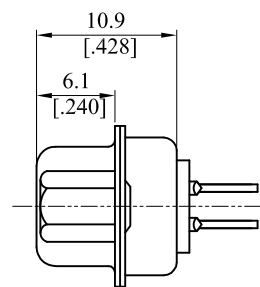
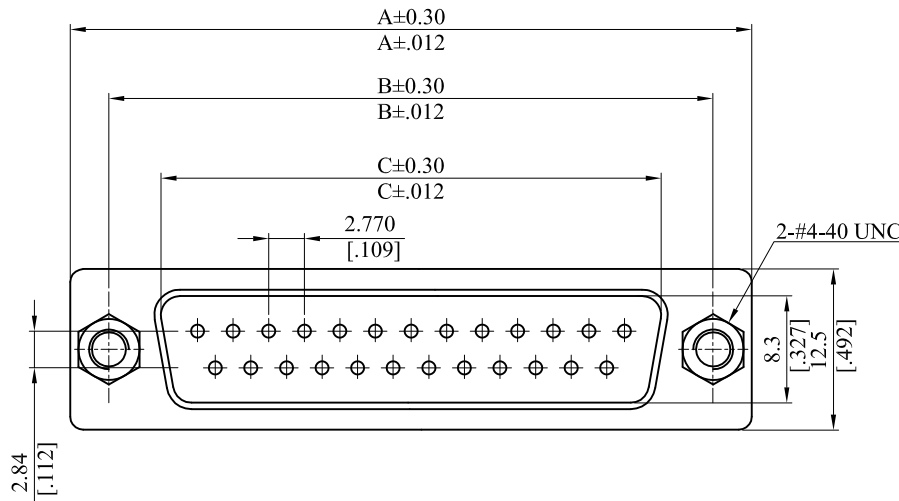
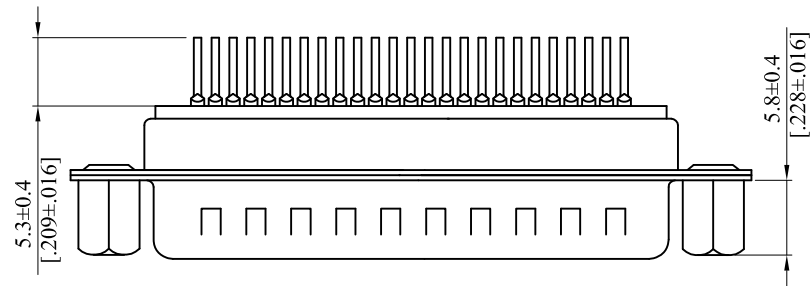

Note:

Material:
 Insulator: Thermoplastic, UL94V-0, Black
 Contact: Brass
 Shell: Steel
 Nut: Brass

General part number:

D * - ** PT * CD2
 1 2

- 1.No.of circuits:
 DE-09=09 circuits
 DA-15=15 circuits
 DB-25=25 circuits
 DC-37=37 circuits

2.Plating:

U=Gold flash over 30μ" min. Nickel underplating overall
 W=15μ" min. Gold over 30μ" min. Nickel underplating overall
 Z=30μ" min. Gold over 30μ" min. Nickel underplating overall
 F=Selective Gold flash on contact area over 30μ" min. Nickel underplating overall, Tin plated on solder tails
 J=15μ" min. Selective Gold on contact area over 30μ" min. Nickel underplating overall, Tin plated on solder tails
 K=30μ" min. Selective Gold on contact area over 30μ" min. Nickel underplating overall, Tin plated on solder tails

Dimensions:

Circuits	Dim.A	Dim.B	Dim.C
9	30.8(1.213)	24.99(.984)	16.92(.666)
15	39.1(1.539)	33.32(1.312)	25.25(.994)
25	53.0(2.087)	47.04(1.852)	38.96(1.534)
37	69.3(2.728)	63.50(2.497)	55.42(2.182)

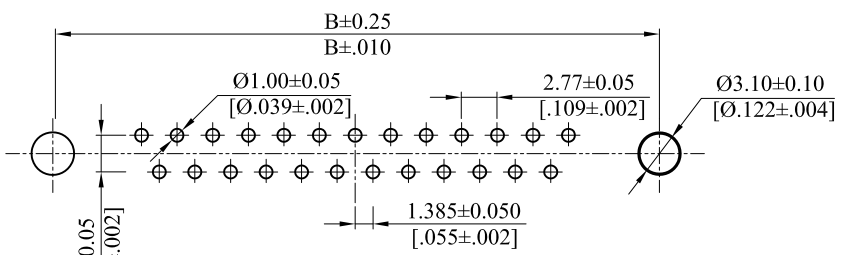

Recommended PCB Layout

TOLERANCE UNLESS OTHERWISE SPECIFIED		LEOCO CORPORATION http://www.leoco.com.tw	
mm	inch	APPROVED BY:	DATE:
[inch]		Chard	2016.10.12
1 PLACE	± 0.30	TITLE:	Top Entry PCB Mount D-SUB Plug
2 PLACES	± 0.20	CHECKED BY:	
3 PLACES	± 0.10	Angle	DATE:
4 PLACES	± ---		2016.10.12
ANGULAR ±1°		DRAWN BY:	DATE:
		Tess	2016.10.12
SIZE:	A3	SCALE:	1:1
		DRAWING NO.:	REV.:
		DPT101S	B
		SHEET:	1 OF 1